

SPECIFICATIONS

[General Specifications]

Model		LU7-02S(K)-USB	
Rated Voltage		5 V DC (USB bus power)	
Operating Voltage Range		Rated Voltage $\pm 5\%$ ※ Based on USB2.0 Standard	
Rated Current Consumption	Max.	500mA ※ With load of 3 LED Units and Buzzer sounding	
Operating Ambient Temperature		-20°C to +60°C	
Operating Ambient Humidity		Less than 90% (No condensation)	
Storage Ambient Temperature		-35°C to +65°C	
Storage Ambient Humidity		Less than 90% (No condensation)	
Mounting Location		Indoors	
Mounting Direction		Upright	
Protection Rating		IP65 (IEC 60529)	
Environmental Condition		Mounted in the upright position	
Vibration Resistance IEC 60068-2-6	LED Unit	0~3 Tiers	10m/s ² , 10~150Hz
		4~5 Tiers	5m/s ² , 10~150Hz
	※Direct Mounting , Wall Mount Bracket (SZ-018□ only)		
Buzzer Frequency		13 Variations	
Buzzer Sound Pattern		5 Patterns	
Sound Pressure Level		80±5dB	
Environmental Condition		Front direction from the center at 1m , DIP Switch : "H" , Buzzer Frequency : 3520Hz	
Sound Pressure Adjustable		2 levels with the DIP Switch (Factory Setting : "H") "H" ↔ "L" : -10dB from "H"	
Lighting Patterns(LU7-E-□)		Four flashing and continuous lighting patterns	
Mass (Tolerance $\pm 10\%$)		160 g	
Outer Dimensions		Refer to the Outer Dimension Drawing	
Communication Method		USB2.0 Full Speed	
Software Library (DLL) Supported OS		Windows 7(Not including Windows 7 Starter) , Windows 8(Not including Windows 8 RT)	
Conformity Standards		FCC Part15 SubpartB Class B EMC Directive (EN 61000-6-2, EN 61000-6-3) RoHS Directive (EN 50581) KC Certification	
Remarks		<p>Conforms to the CE requirements</p> <p>* Cannot connect two or more LED units (LU7-E-□) of the same color.</p> <p>* A maximum of three lighting LED units is allowable (LU7-E-□). (Cannot exceed Four units, or product will malfunction.)</p> <p>* No other LED units (LU7-E-□) can be connected.</p> <p>* Luminous intensity is based on about 50~70% of the standard brightness value of the LED unit (LU7-E-□).</p> <p>● Model Number Configuration</p> <p>LU7-02S□-USB</p> <p>└ Body color Blank : Light Gray K : Black</p>	

No. LU7-02S-USB-W18A-1_2

PATLITE Corporation

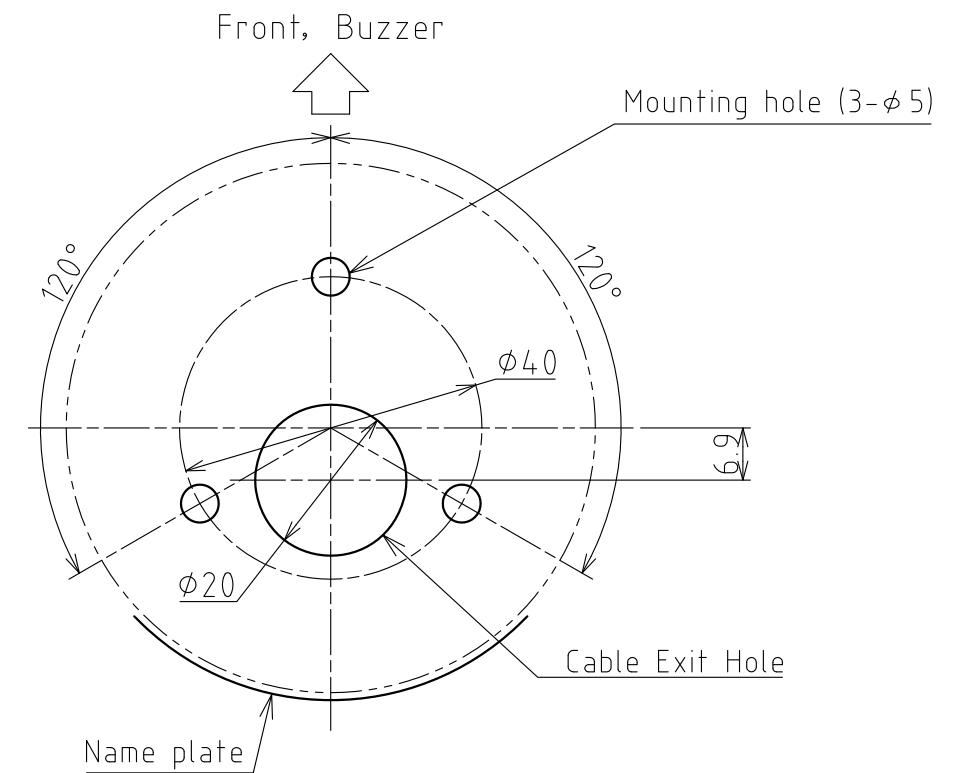
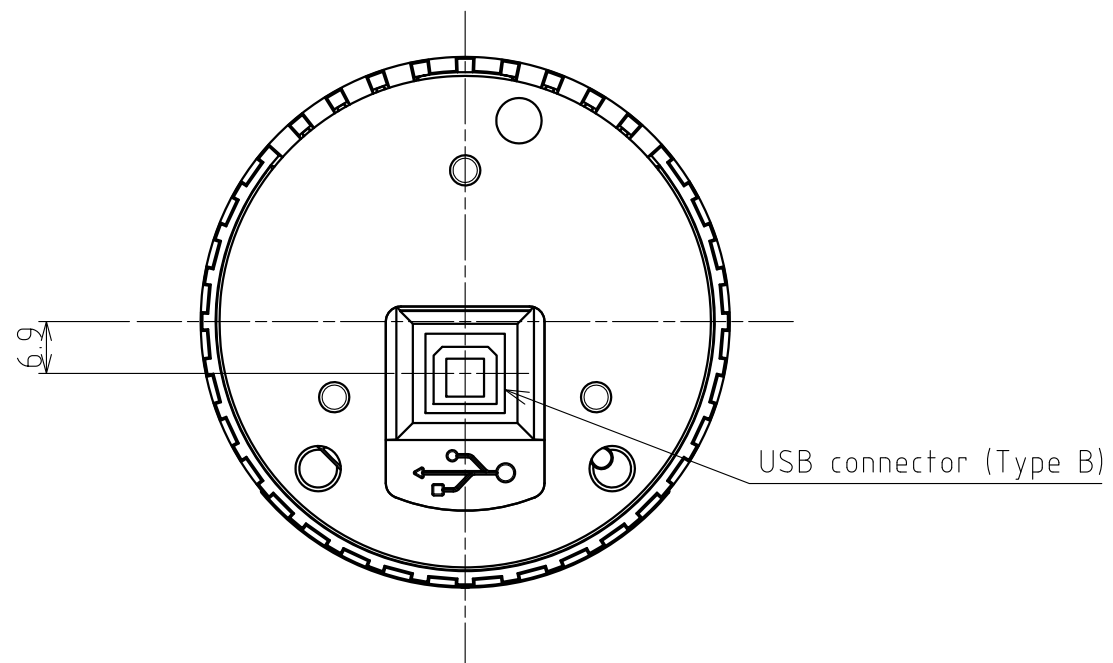
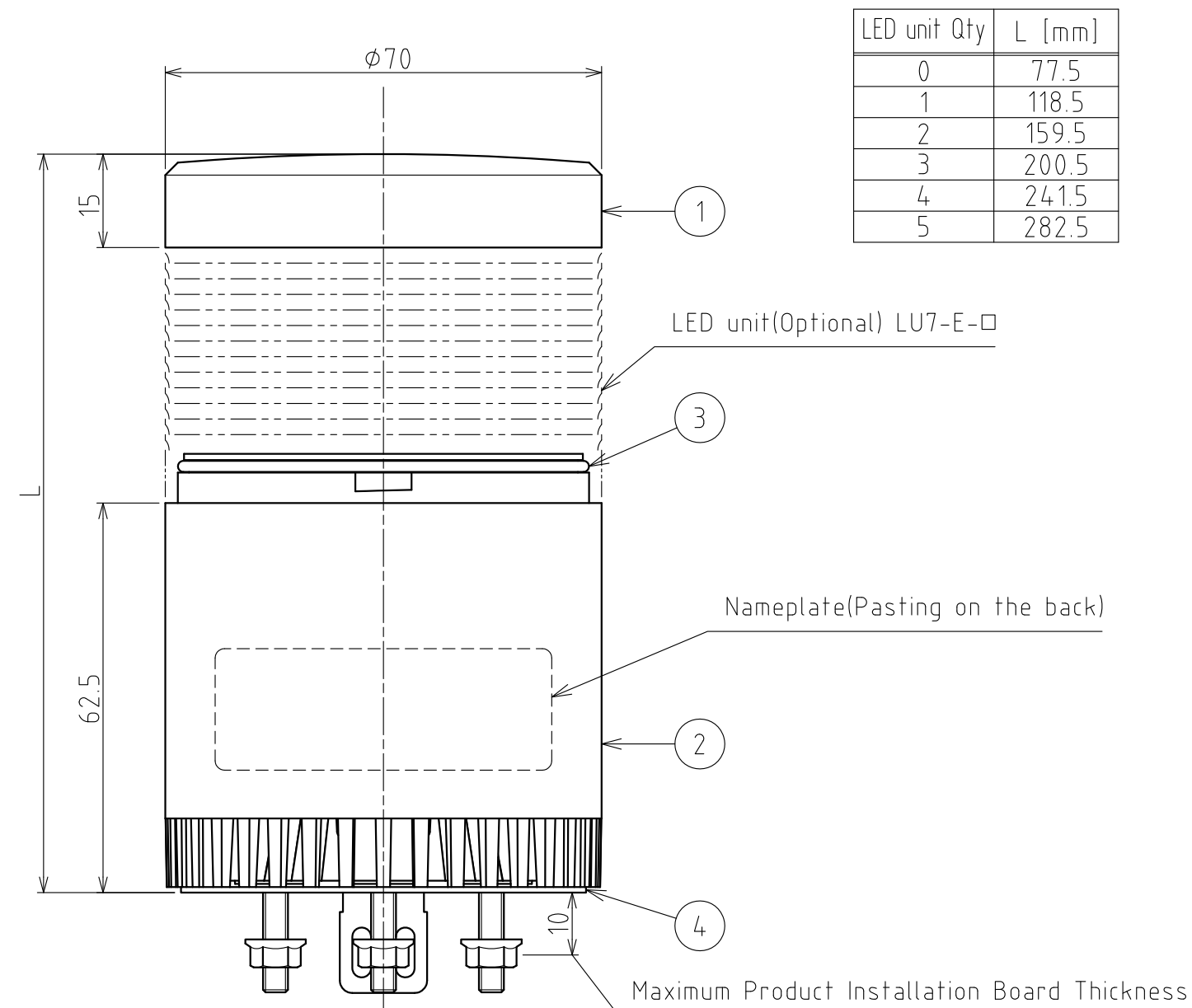

Installation Dimension Drawing

4	Water proof sheet		1	CR t=2.0	
3	O-ring		1	Silicon rubber φ1.78 Gray	
2	Bracket		1	ABS Light Gray/Black	
1	Head Cover		1	ABS Light Gray/Black	
番号 No.	部品名 Part Name	品目コード Part No.	数量 Qty.	材料 & 寸法 & 処理 Material & Size & Finish	記事 Remarks

LU7-02S(K)-USB
Outer Dimension Drawing

株式会社 パトライト
PATLITE Corporation

LU7-02S-USB-W18A-2_2